

ÁREA EXISTENTE 153,42 M²
ÁREA A AMPLIAR 29,70 M²
ÁREA TOTAL 183,12 M²

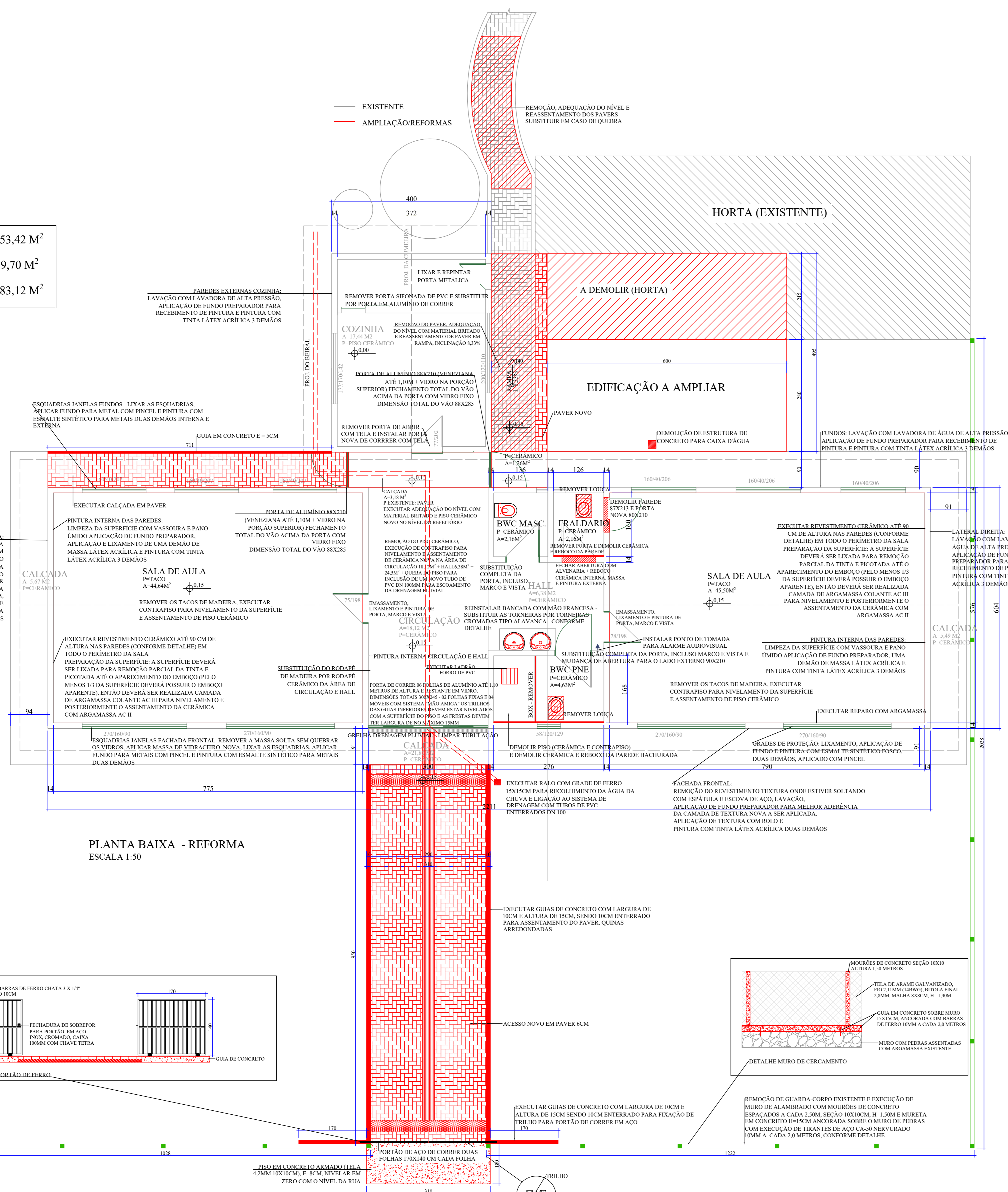

PLANTA BAIXA - REFORMA
ESCALA 1:50

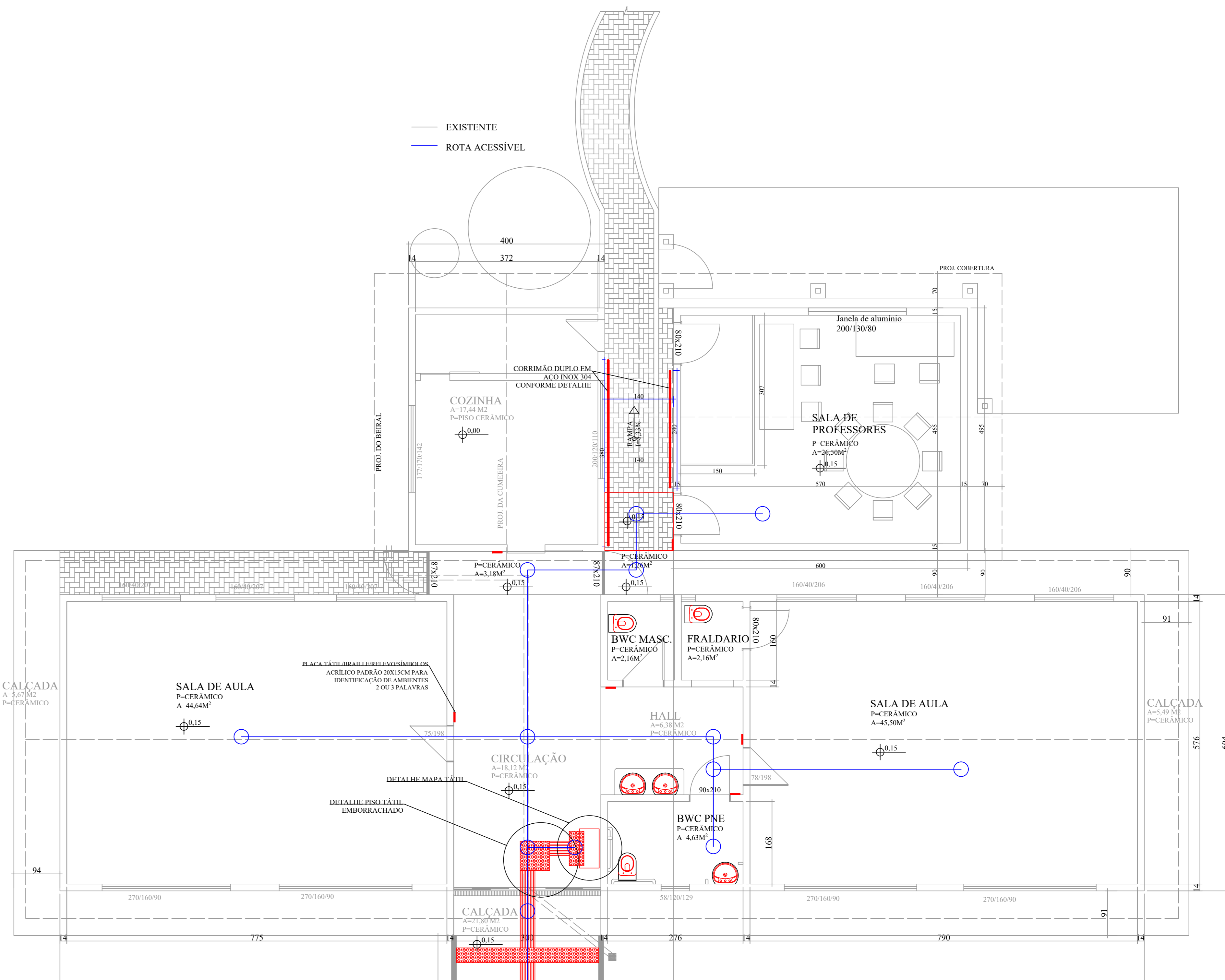

PLANTA BAIXA - ACESSIBILIDADE
ESCALA 1:50

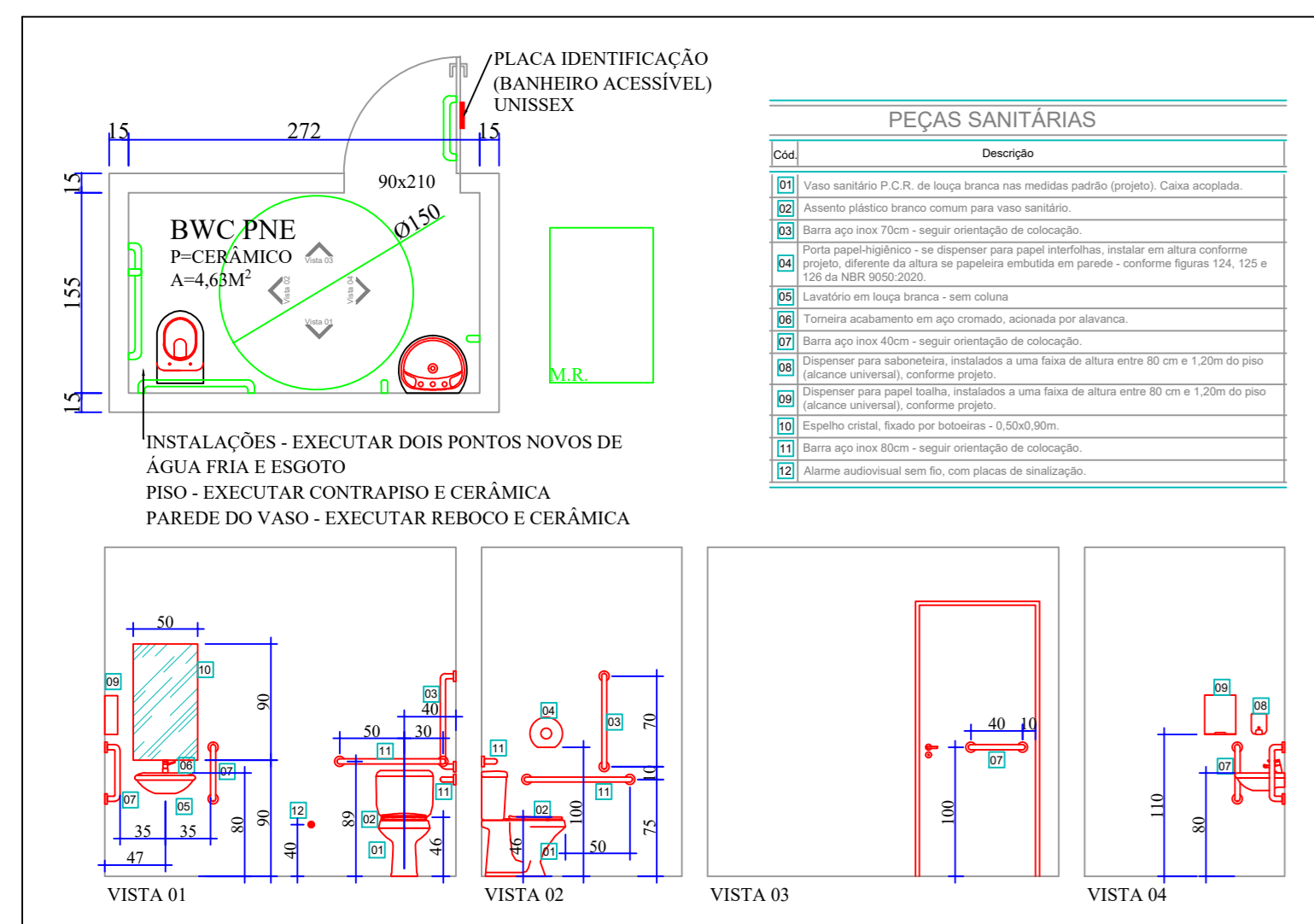
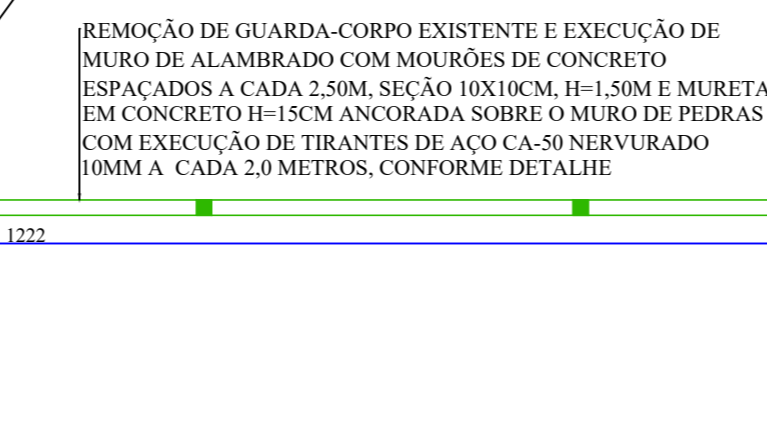
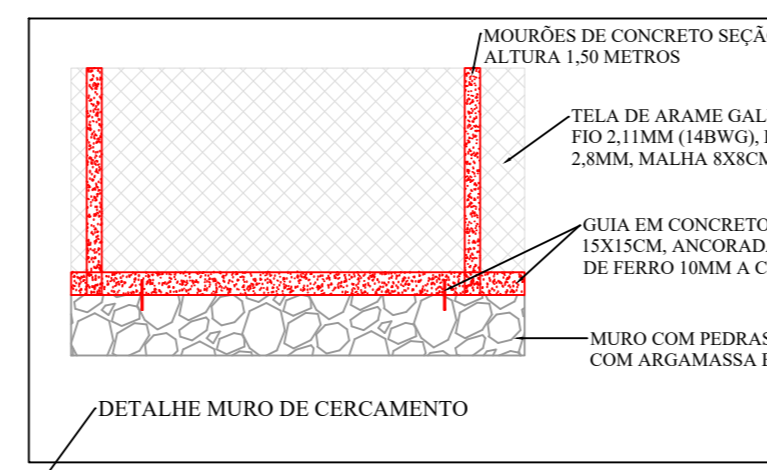
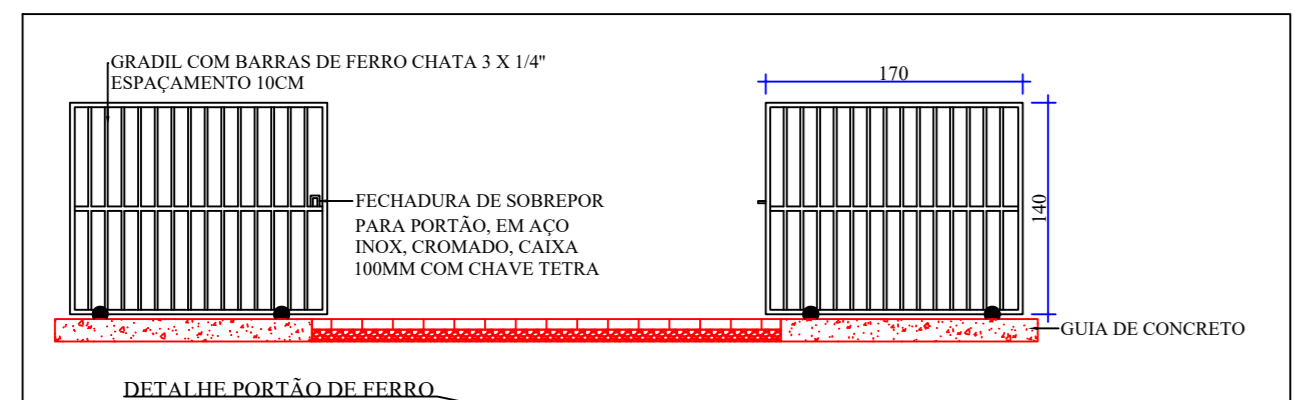

DETALHE BANHEIRO PNE
ESCALA 1:50

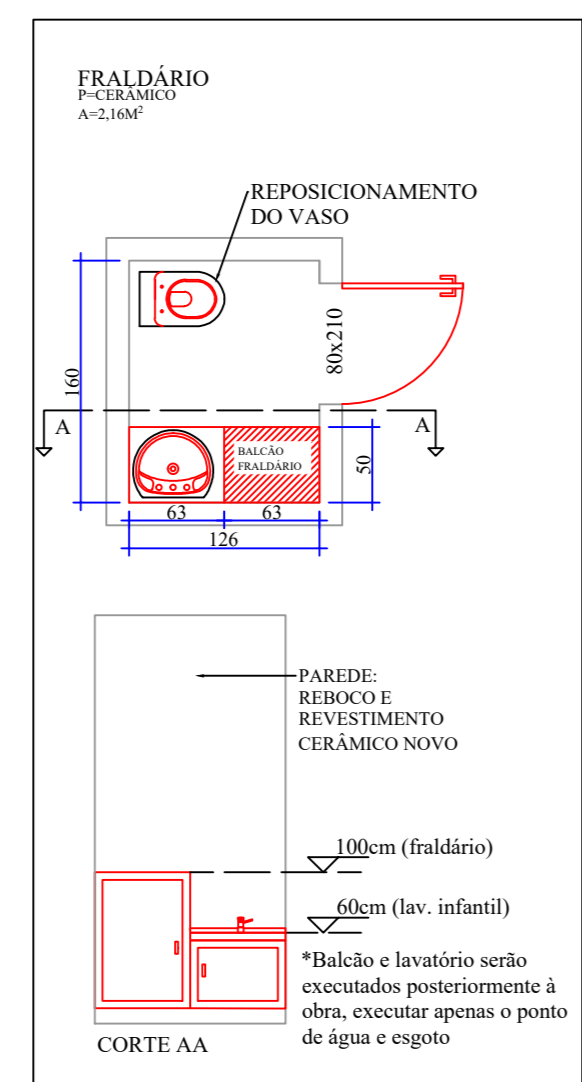

DETALHE FRALDÁRIO
ESCALA 1:50

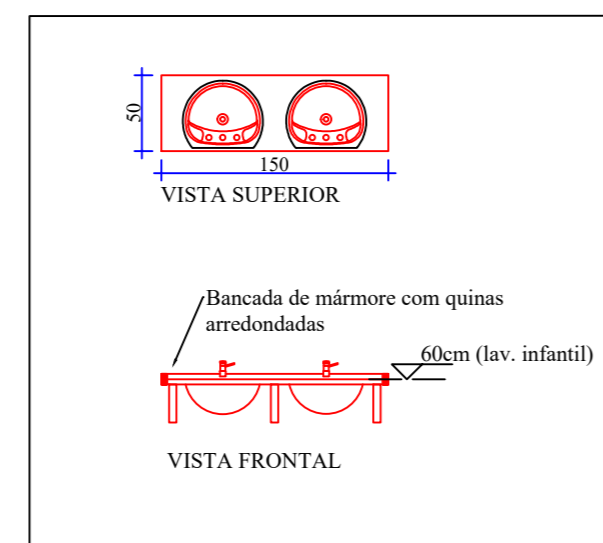

DETALHE LAVATÓRIOS
CORREDOR ESCALA 1:50

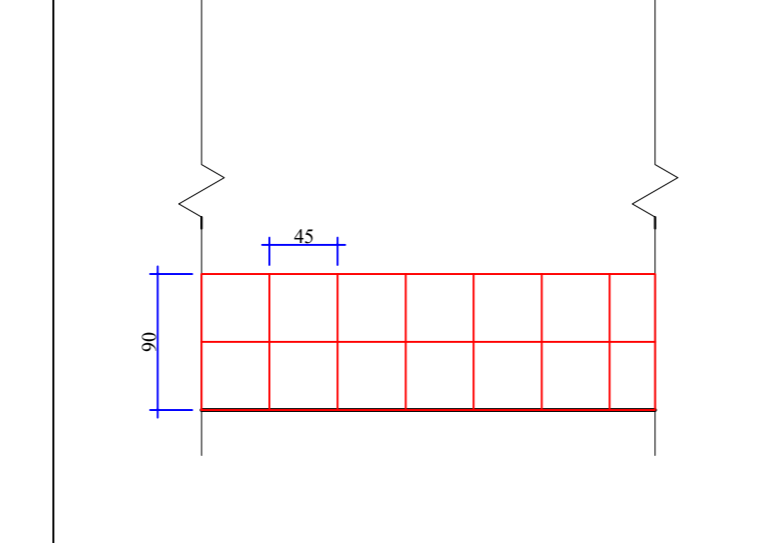

DETALHE CERÂMICAS
PAREDES ESCALA 1:50

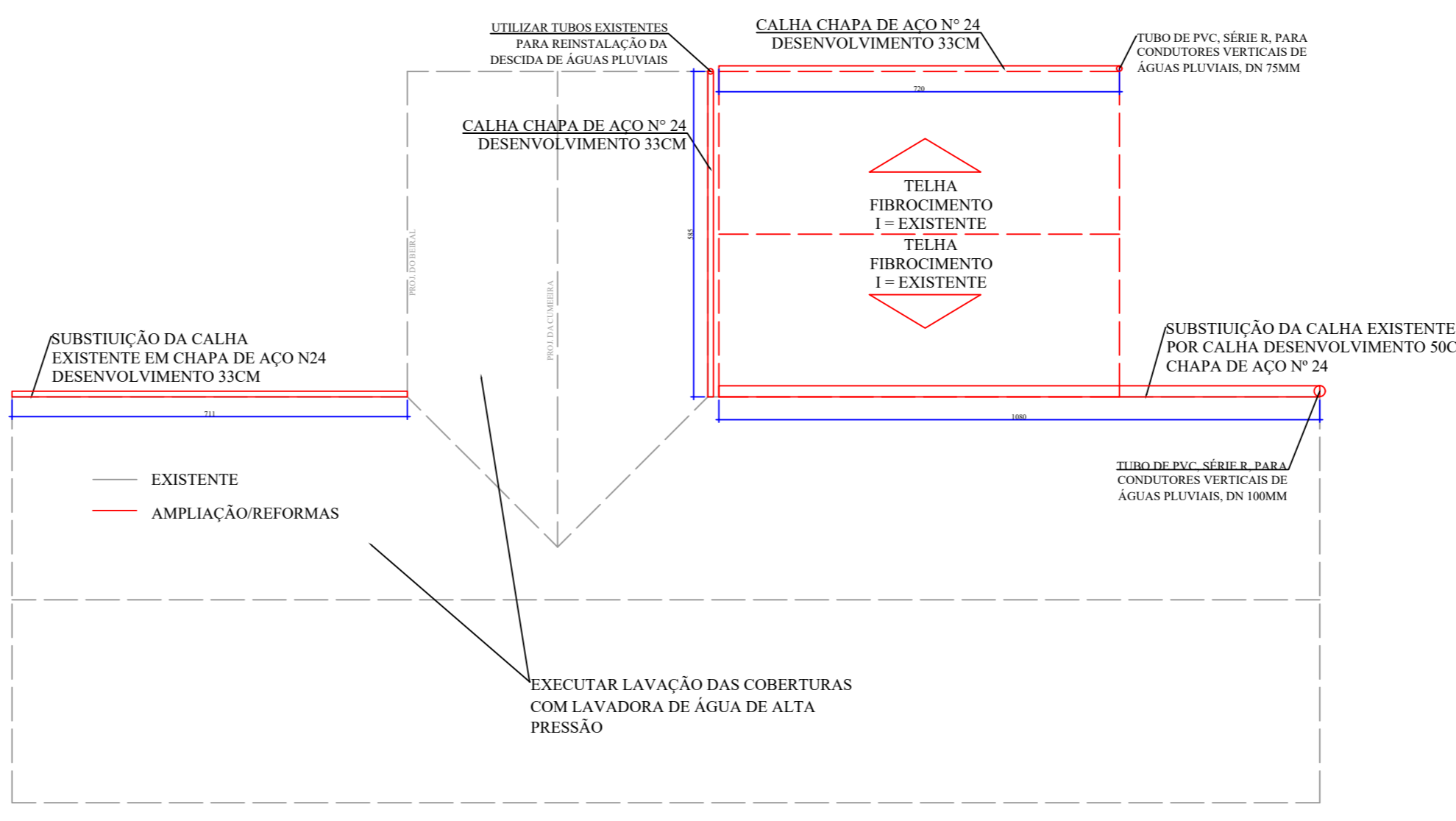

COBERTURA
ESCALA 1:100

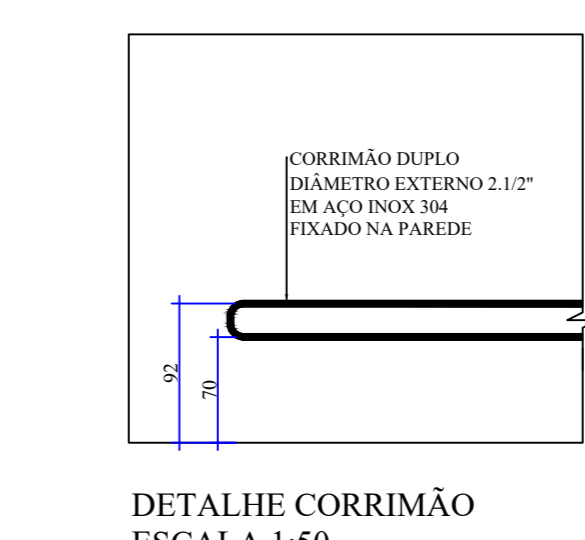

DETALHE CORRIMÃO
ESCALA 1:50

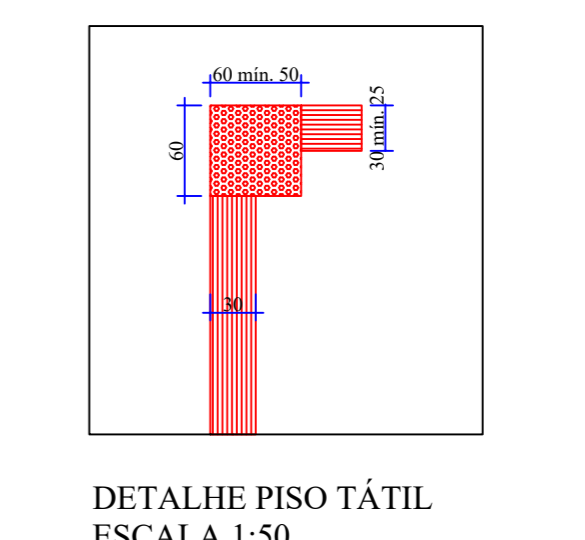

DETALHE PISO TÁTIL
ESCALA 1:50

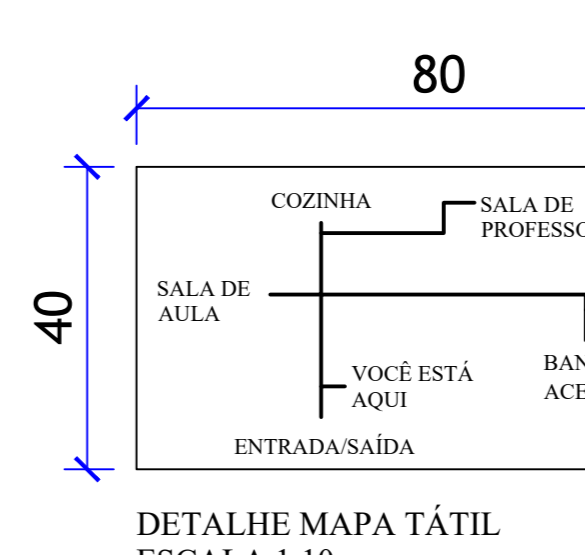

DETALHE MAPA TÁTIL
ESCALA 1:10

PREFEITURA MUNICIPAL DE PRESIDENTE CASTELLO BRANCO
ESCOLA MUNICIPAL DE LINHA TAQUARAL
 PROJETO: ADAPTAÇÃO À ACESSIBILIDADE / REFORMA / AMPLIAÇÃO

ENERGIA DA OBRA: Linha Taquaral - Interior - Presidente Castello Branco - SC	ESCALA: Indicada	FRANCA:
DISCIPLINA: PLANTA BAIXA - REFORMA E ACESSIBILIDADE	DATA: 02/2022	01/02
DESENHO: COBERTURA	PROJETADO: RENAN MARCOS MURARO	RESP. EXECUÇÃO: NEIVA KL. EEMANN, FONSELO

ANO 2022 - FICAM reservando os direitos autorais de reprodução de qualquer natureza em favor de: S. 2.044.